

Falcon Quick Start Guide

V1.2

2021.01

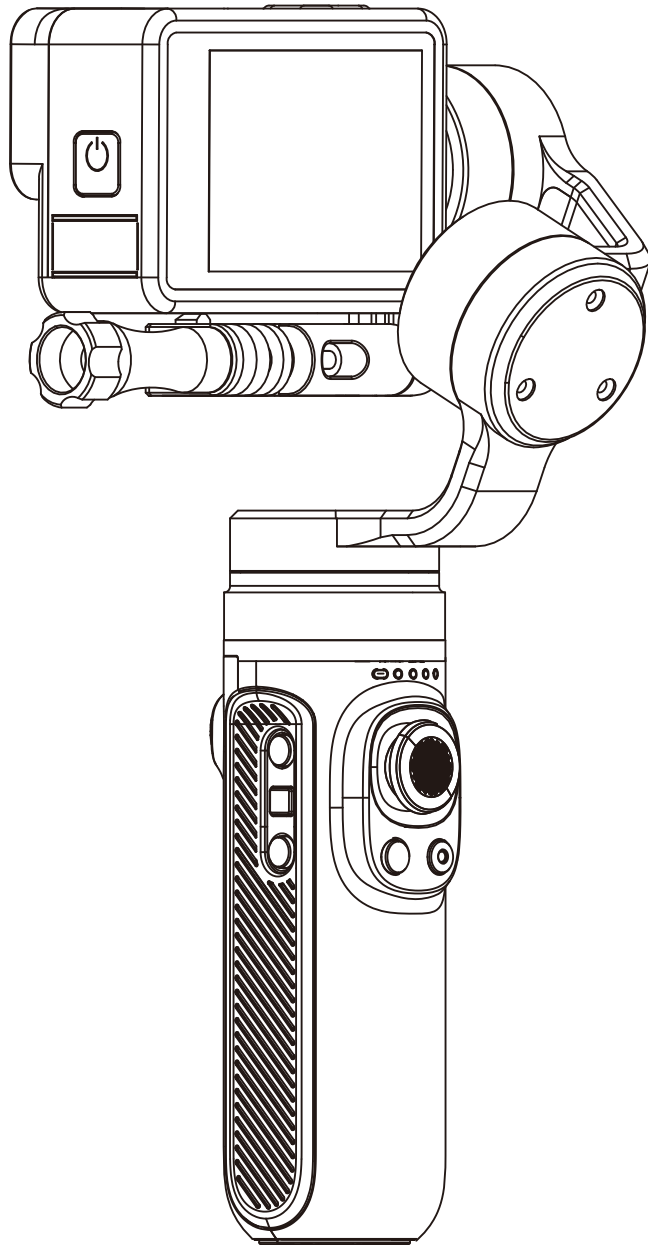

Contents

Introduction	1
Product Contents	1
Falcon diagram	2
Product Usage	3
Charging	3
Installation of Action Camera	3
Power Button	4
Shutter Button	4
Function Operation	5
Mode Function	5
Four-directional Joystick Operation	7
Mode Switch Button	7
Trigger Button Operation	8
Manual Lock	9
Indicator Light Status	9
Disclaimer	10
Product Parameter	11

Introduction

Falcon is a hand-held stabilizer specially designed for cameras, which supports most of Action Cameras on the existing market, Through the three-axis motion compensation to stabilize the Action Camera to get a stable effect.

Product Contents

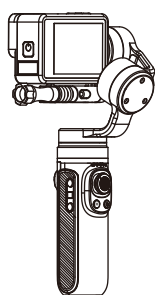

Stabilizer x1



Charging Cable x1

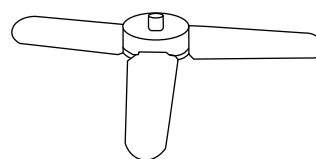

Tripod x1

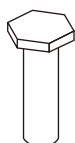

Screw x1

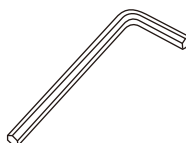

Hex Key Wrench x1

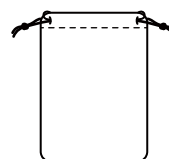

Storage Bag x1

Falcon diagram

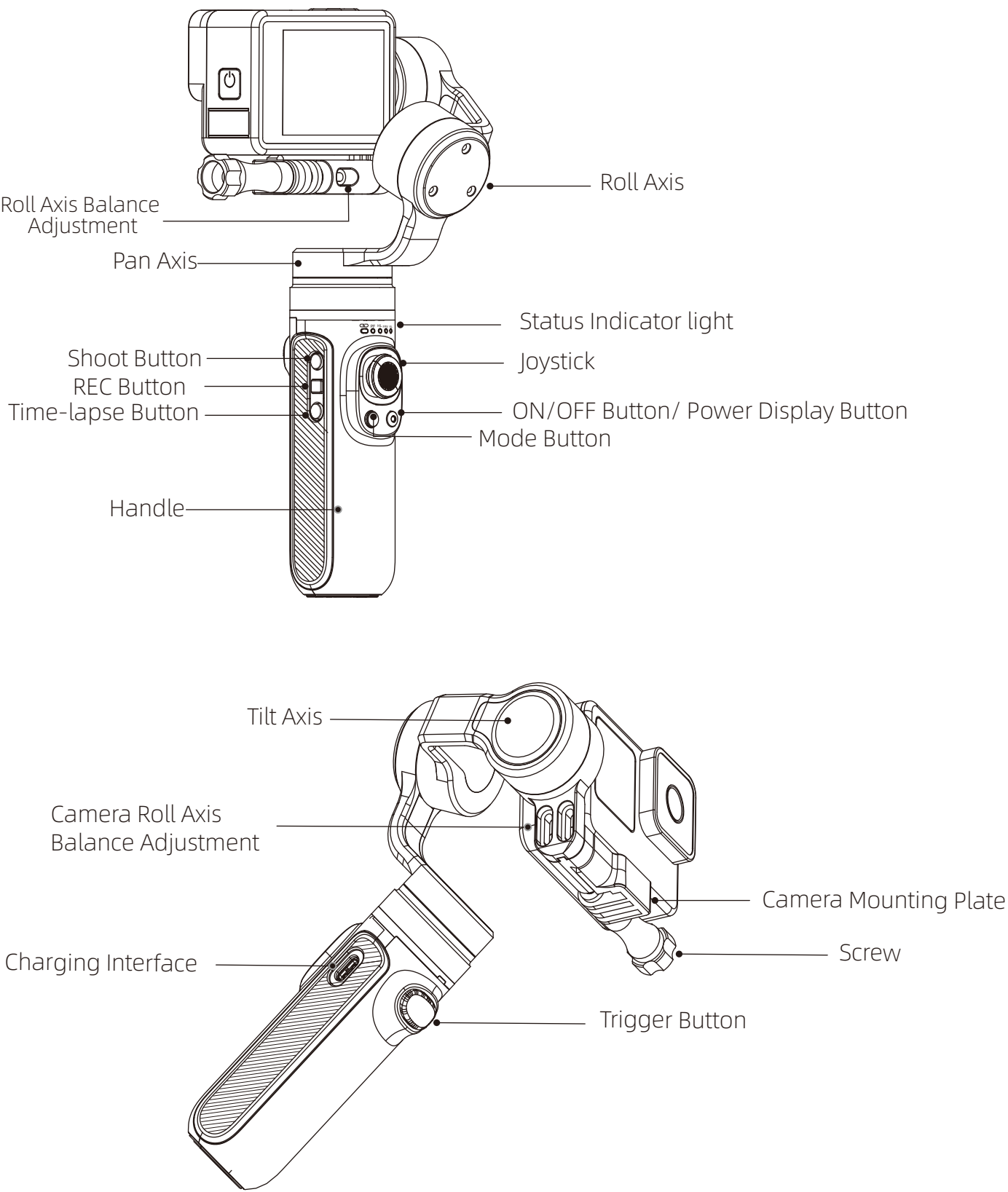

• Camera not included.

Product Usage

Charging

Use TYPE-C cable to charge. The status indicator is red when charging while the green light is always on when fully charge.

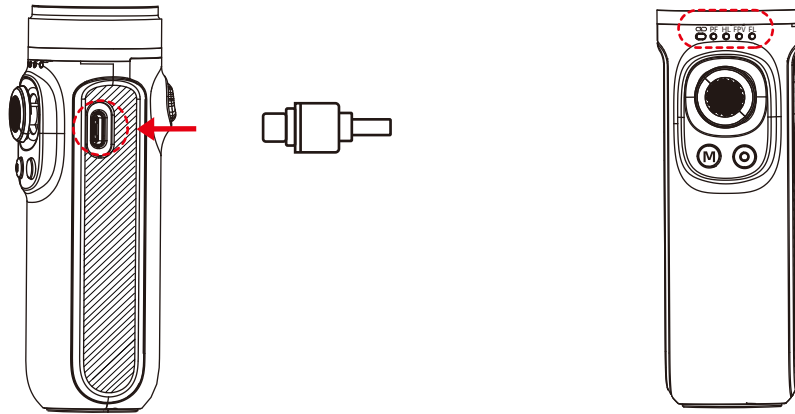

- ⚠ Note :
- Make sure to fully charge the stabilizer when use for the first time.
 - Please charge the stabilizer immediately if the power is too low and the red-light flashes slowly.
 - Turn off the power if not in use.

Installation of Action Camera

Take GoPro HERO9 as an example:

- ① Pull apart the bottom mounting buckle of the action camera and install it on the stabilizer.
- ② Insert the screw into the hole corresponding to the stabilizer and then tighten the screw.

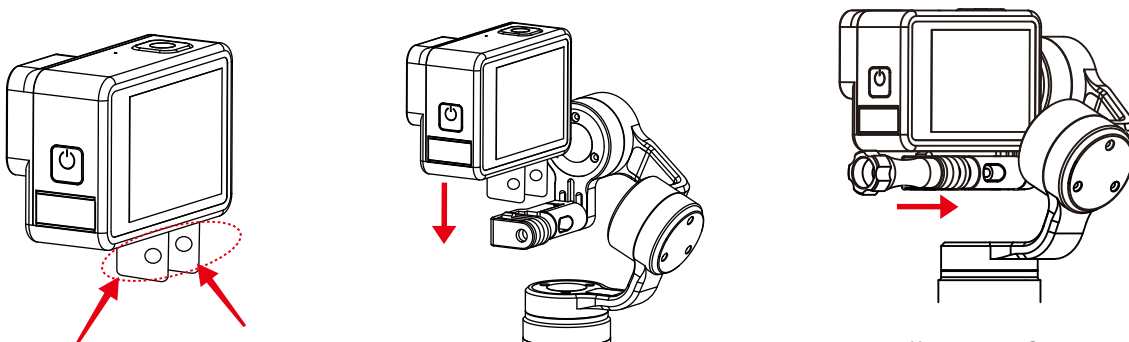

Installation of camera is completed.

Power Button

- ① Under the condition of power on or off, Long press two seconds the power button to turn on or turn off the gimbal.
- ② Under the condition of power on or off, single press the power button to display the power of stabilizer.
- ③ In the boot state, double press the power button into standby mode, and then single press any button to restore the working state of the stabilizer.
- ④ In the boot state, continuously and quickly press eight times to clear the remote-control pairing. Too slow will trigger standby.

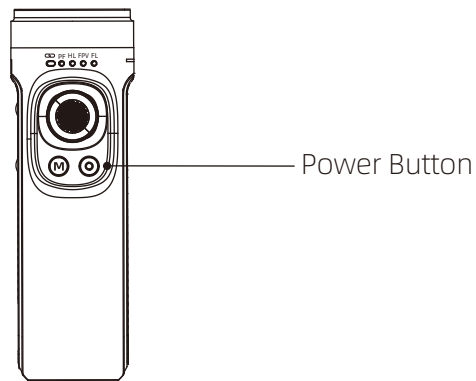

 Note: The Action Camera can only be turned on after it is firmly installed.

Shutter Button

Shooting Button: Single press to shoot

REC Button: Single press to start recording or stop.

Time-lapse Button: Single press the button to start time-lapse shooting or stop.

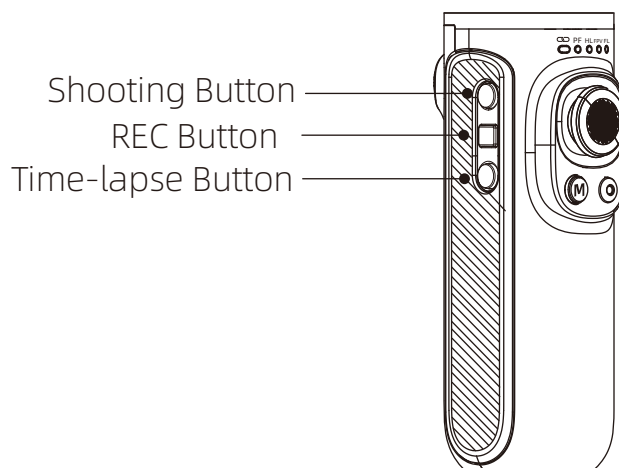

Function Operation

Mode Function

① Following Mode

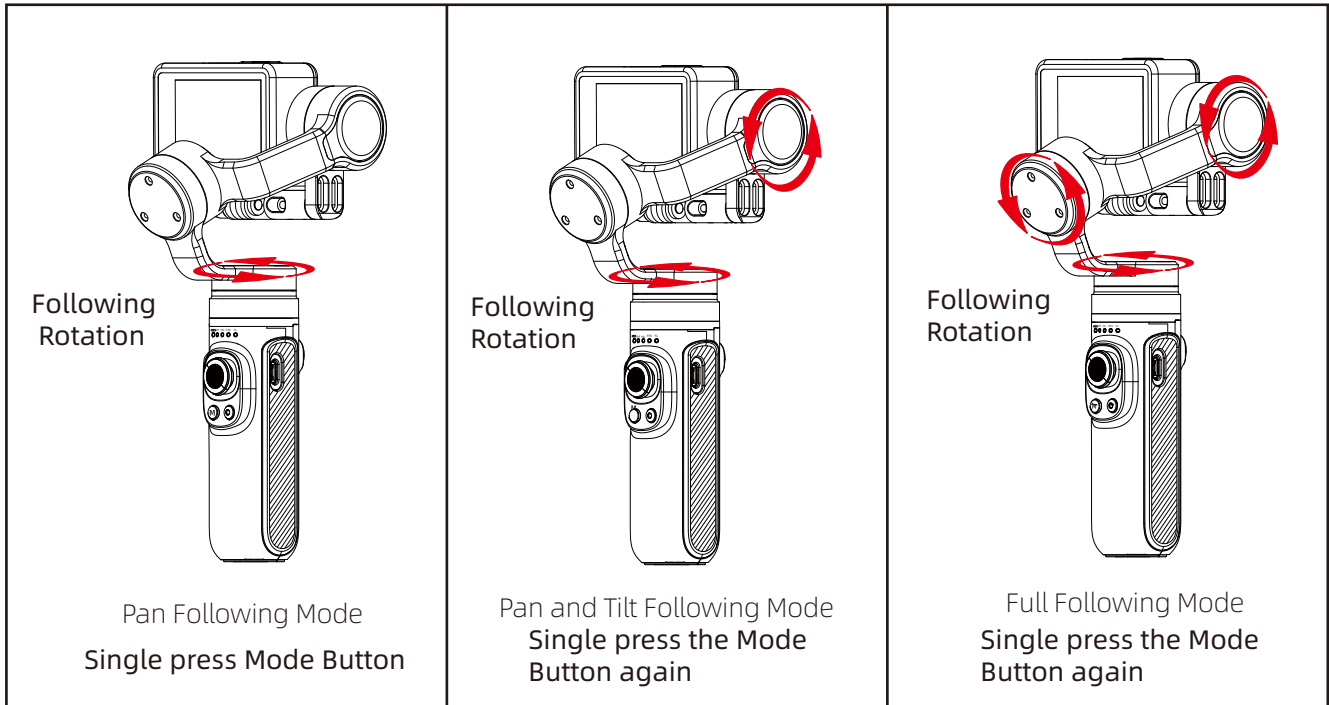

② Lock Mode

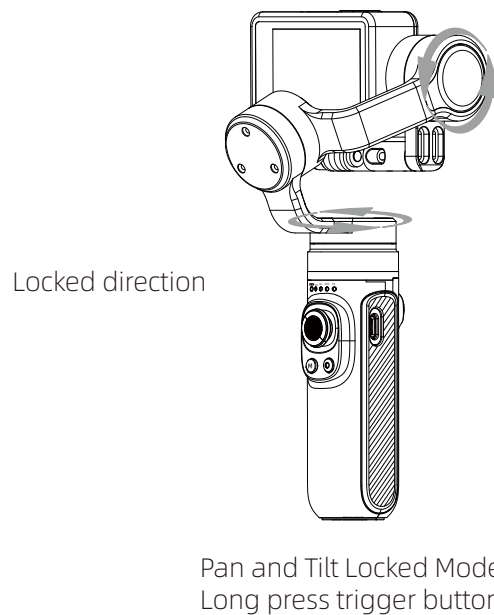

⚠ The red circle indicates that the motor follows the movement of the handle to change the angle, while the gray circle indicates that the motor locks the angle and does not follow the movement of the handle.

Falcon Quick Start Guide

③ Vertical shooting Mode and Flashlight Mode

Double click to enter vertical shooting mode, double click again to enter Flashlight Mode. Single click to exit to HL mode.

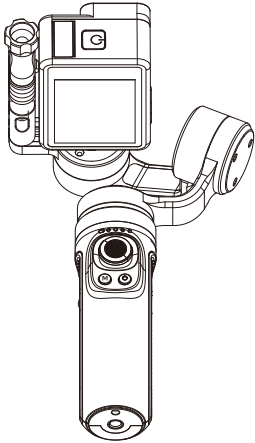

Vertical Shooting Mode

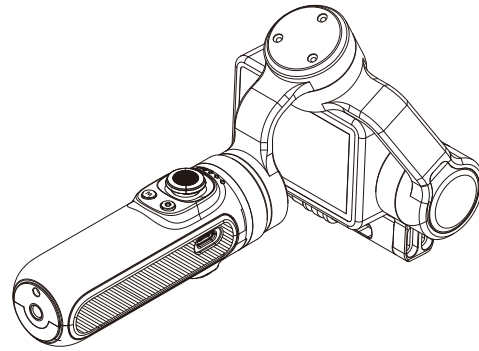

Flashlight Mode

Mode	Description
Pan Following Mode (default)	Tilt axis and roll axis keep the same direction, and the lens rotates with the direction of the handle.
Pan and Tilt Following Mode	Roll axis keep the same direction, and the lens rotates with the direction of the handle.
Lock Mode	The lens keeps the same direction.
Reset	Return to Pan Following Mode, tilt axis, roll axis and pan axis return to horizontal state.
Trigger Lock	Pull the camera to the specified angle of pan axis and tilt axis for half a second to lock the current angle.
Horizontal/Vertical Shooting	Help the camera to shoot horizontally or vertically.

Trigger Button Operation

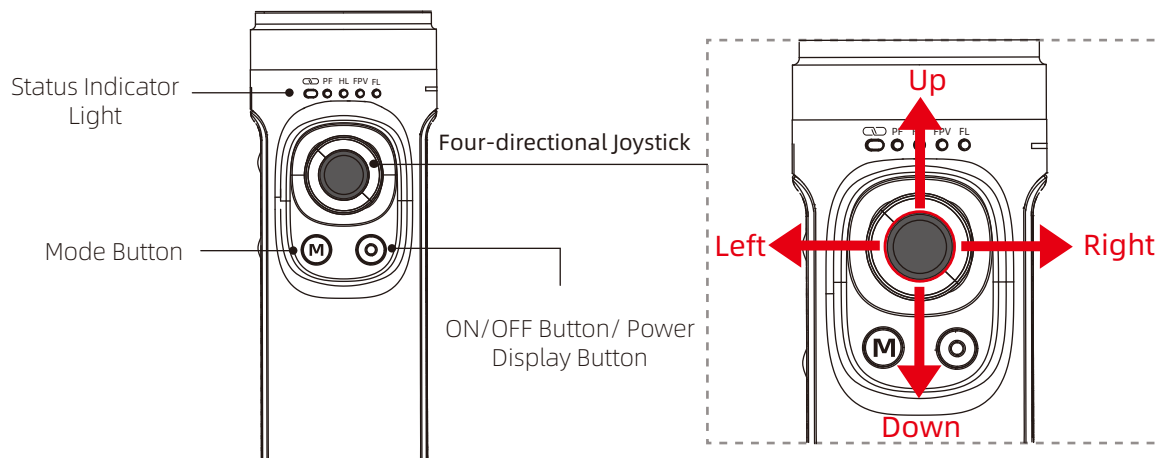

Joystick Operation	Description
Push upwards /downwards	Tilt axis rotates up or down
Push left/right	Pan axis rotates left or right.

Mode Switch Button

1、Illustration

- ① Single click to switch PF-HL-FPV mode.
- ② Double click to enter vertical shooting mode, double click again to enter Flashlight Mode.
Single click to exit to HL mode.
- ③ Long press the Trigger Button to enter GL Mode(Lock Mode), release to back to previous mode(GL Mode works only under PF or HL Mode).

2、The current mode of the stabilizer can be identified by the status of the indicator light.

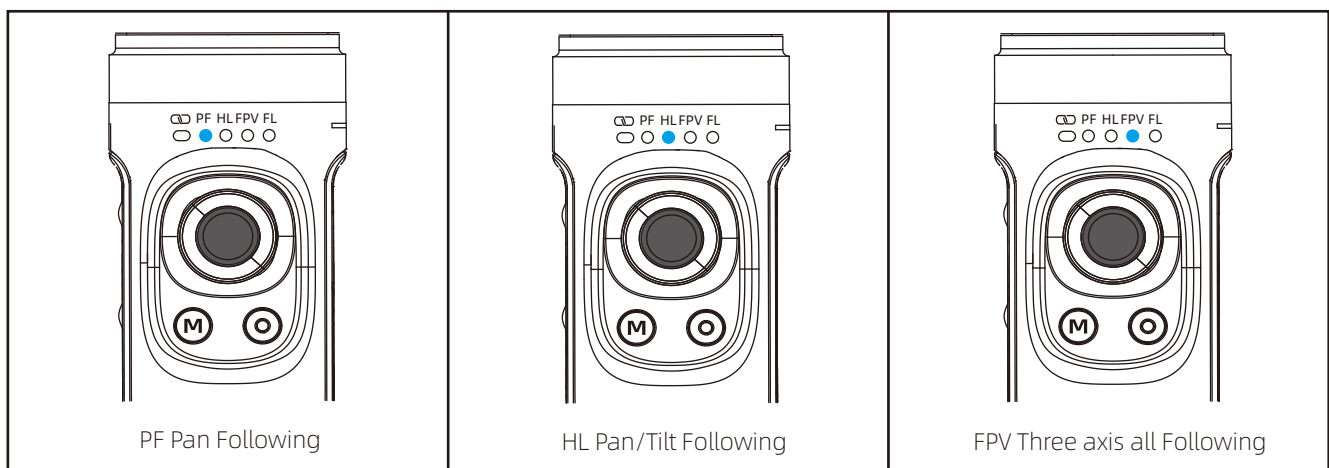

Falcon Quick Start Guide

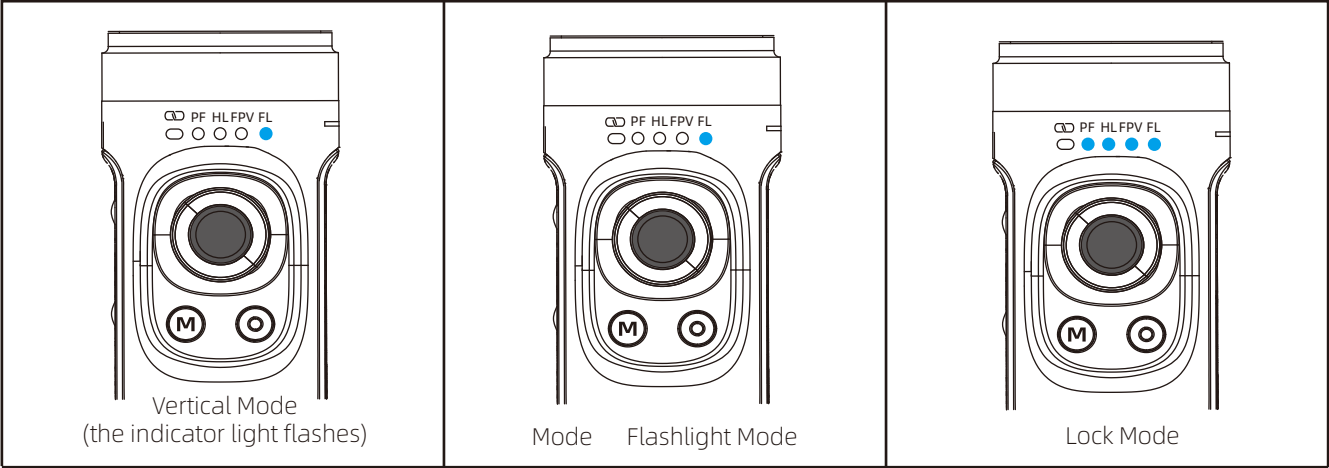

Trigger Button Operation

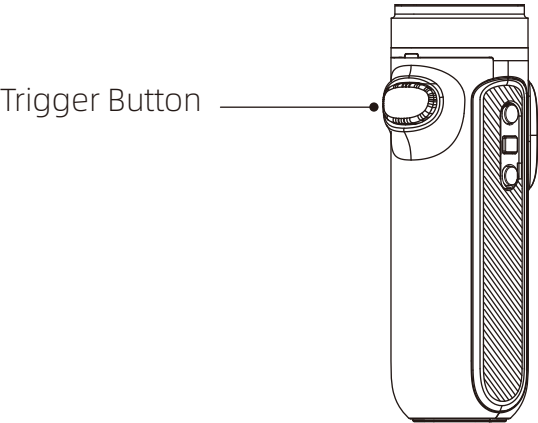

Trigger Button Operation	Description
Press and hold	Into GL mode (release will back to previous mode)
Double press	Reset (Tilt axis and roll axis)
Three-times press	Pan axis rotate 180. Tilt axis and roll axis back to original position.

Manual Lock

Grasp the camera and pull it to the specified angle in the tilt direction, stay for half a second and then lock the current angle.

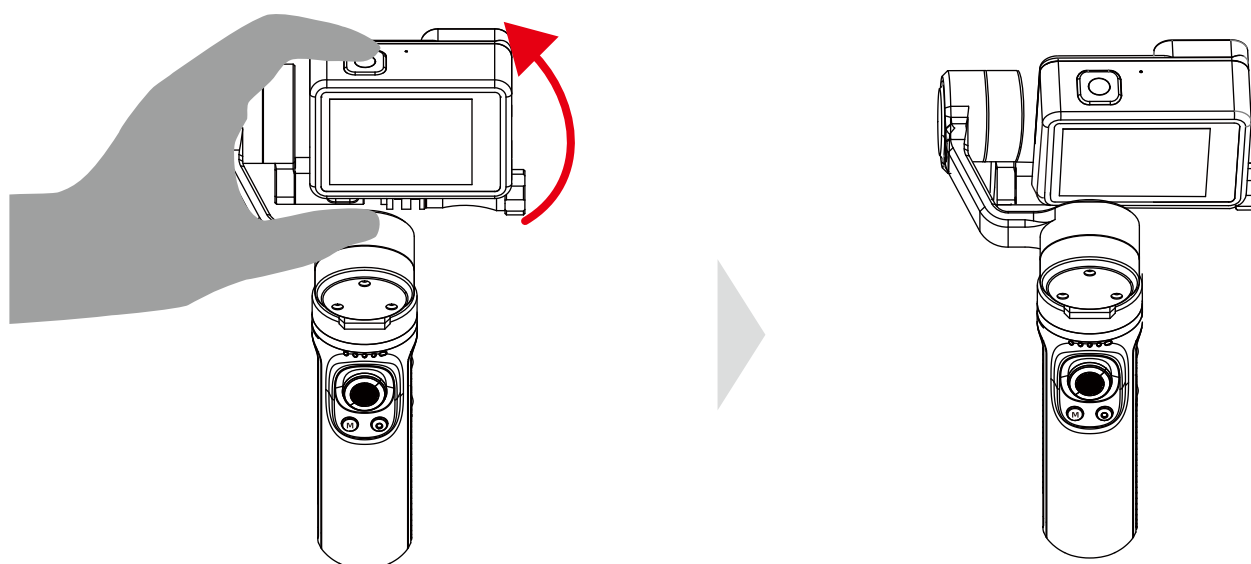

Indicator Light Status

Indicator Light Status	Description
Blue LED Light	Power off and standby mode shows the current power from left: 0-25%, 25-50%, 50-75% and 75-100%.
	After power on the stabilizer, it represents the mode status from left to right: Following mode (PF), Lock mode (HL), FPV mode, Flashlight mode (FL); under GL mode all LED lights are on.
Green LED Light	Display the Bluetooth connection status. It is always on when the Bluetooth is connected while it is always off when no connection. After pairing is cleared, the light will flash slowly during the Bluetooth scanning, if there is connected then always on if not then off light.
Red LED Light	Display the current upgrade status. The red-light flashes rapidly during upgrade, and it will turn off after three seconds when upgrade completed. When the power is lower then 10% the red-light flashes slowly, if can't upgrade or upgrade fails then the red light will always be on.

Disclaimer



Warning

The contents mentioned in this article are related to your safety, legal rights, and responsibilities. Please read them carefully and set up and use this product correctly according to the instructions. If you do not follow the instructions and warnings in this article, it may cause harm to you and the people around you and damage the product or the products around you. Any illegal use by any user is prohibited. The user will be responsible for all actions of purchasing and using the product. For this product, the company does not bear all the risks and responsibilities (including direct, indirect, or third-party losses) of the end customers during the debugging and use of this product. Our company will not provide any service for any products obtained from abnormal channels or for unknown purposes.

Note:

- Ensure that the motor rotation is not blocked by external force during and after the stabilizer is powered on.
- Make sure that the stabilizer is not exposed to water or other liquids.
- Do not disassemble the whole stabilizer. If it is disassembled carelessly and causes abnormal operation, please send it back for re-debugging. All the expenses arising therefrom shall be borne by the customer.
- Long time continuous operation may cause the surface temperature of the motor to rise, please operate with caution.
- It is strictly forbidden to fall or collide. Falling or colliding the stabilizer may damage it and cause abnormal operation. In case of abnormal work caused by falling or collision, please contact the after-sales department in time.

Storage and Maintenance

- Please keep this product out of the reach of children and pets.
- It is forbidden to place the product near the heat source (furnace or heater, etc.) and in the car in hot weather.
- Please store in a dry environment.
- Do not overcharge or over discharge the battery, otherwise it will cause damage to the cell.
- Do not use this product in too high or too low temperature environment.

Product Parameter

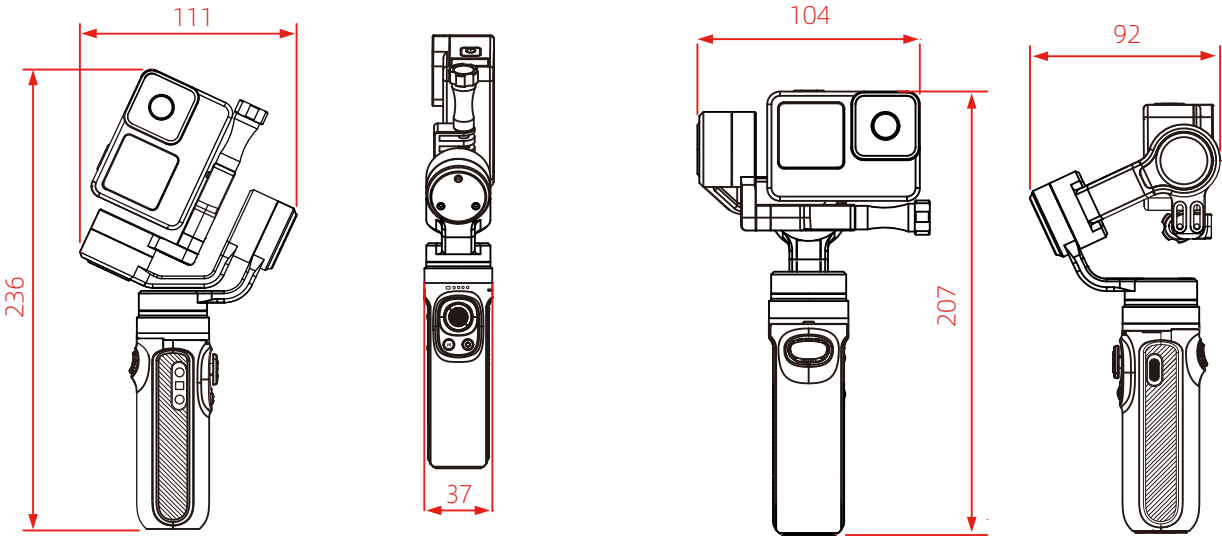

Product Dimension:	236mm×111mm×37mm (Storage status) 104mm×207mm×92mm (Working condition)
Weight:	300g (battery included)
Max. Payload:	135g
Tilt Movement Angle:	310°
Roll Movement Angle:	180°
Pan Movement Angle:	360°
Standby Time:	Laboratory stationary placement test results are 9 hours
Adaptive Reference Model:	Gopro9/8/7/6/5and other action cameras of similar shape and size

Shenzhen Yingzhiqi Technology Co., Ltd

Address: 18A, Ruijun Business Building, No.108, Central Road,
Xinqiao Street, Bao'an District, Shenzhen,
Guangdong Province

Tel: +86 40096 80096

Website: www.in-kee.com

Latest version of the User Manual is available at Official Website:
<http://www.in-kee.com/Falcon>

This manual is subject to update without prior notice. If you have any questions or suggestions about the manual, please contact us at the following email address:
info@in-kee.com

